

D1 Typical Planting, Kerb, Border & Paving Detail
Scale 1:10

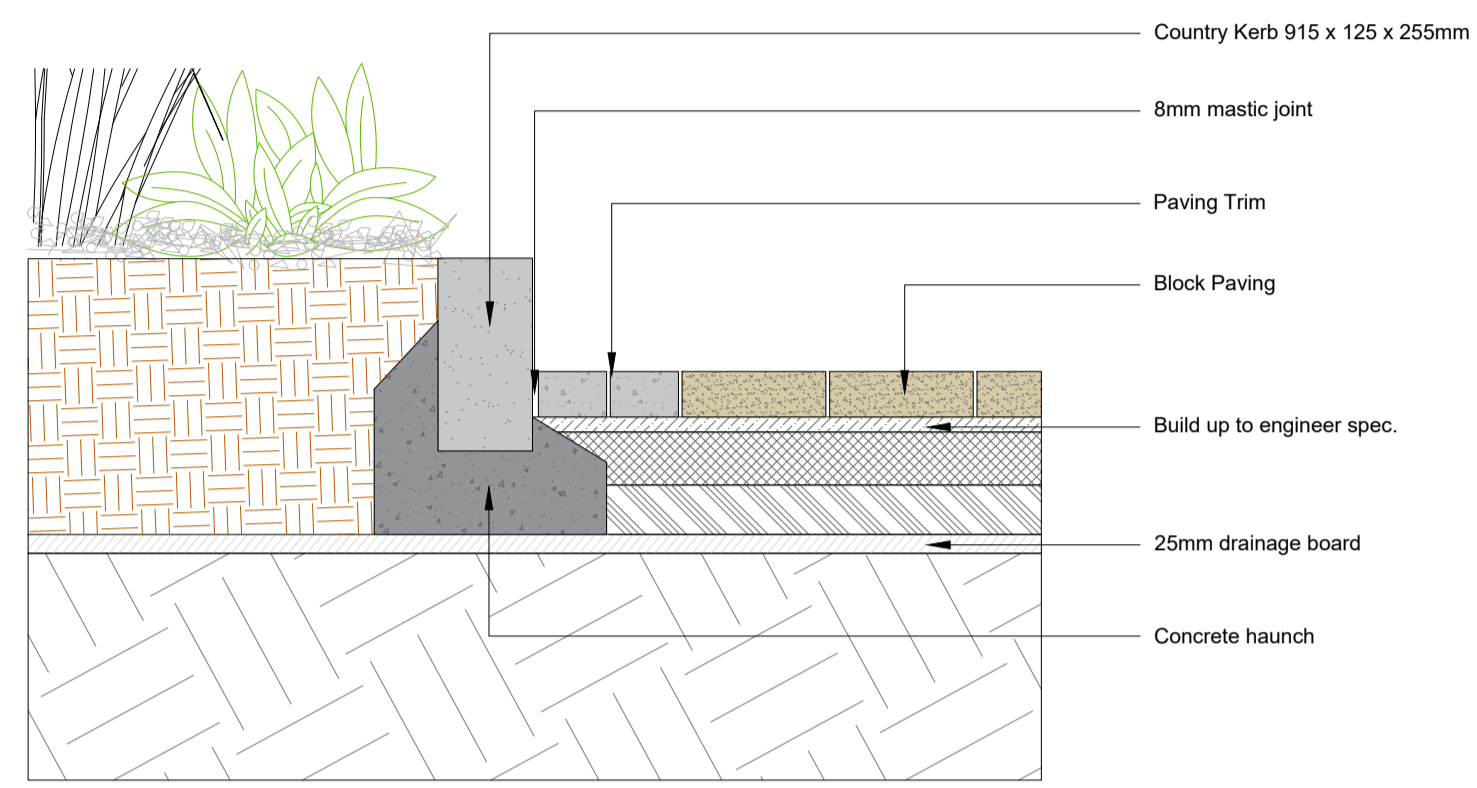

- Country Kerb 915 x 125 x 255mm
- 8mm mastic joint
- Paving Trim
- Block Paving
- Build up to engineer spec.
- 25mm drainage board
- Concrete haunch

D2 Tactile Blister Pedestrian Crossing Paving
Scale 1:20

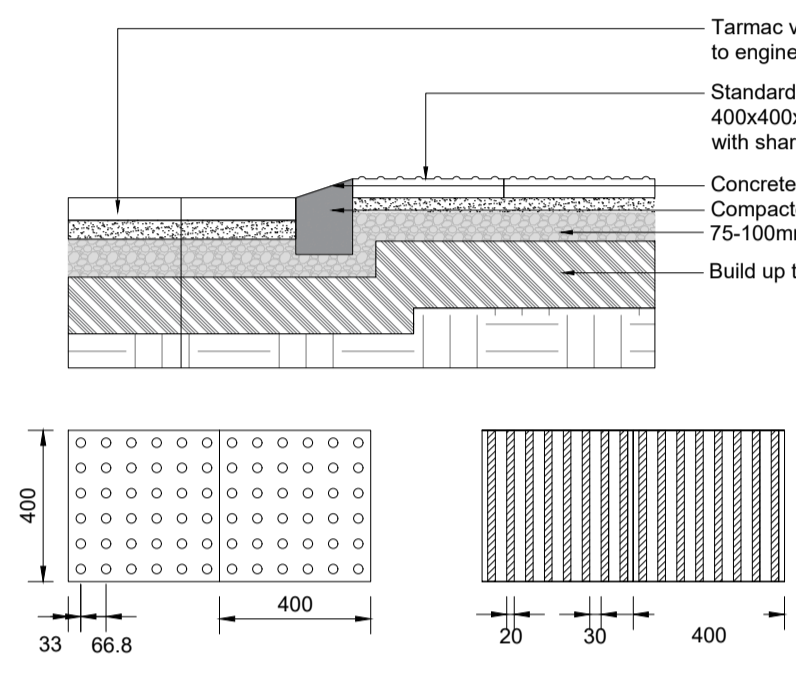

- Tarmac vehicular surface and subbase to engineers specifications.
- Standard tactile blister paving, red colour, 400x400x50mm with 2-5mm joints filled with sharp sand
- Concrete drop kerb to engineers detail
- Compacted sand
- 75-100mm Sub-base
- Build up to engineers spec.

D9 Tree Planting Detail - Hard Landscape
Scale 1:20

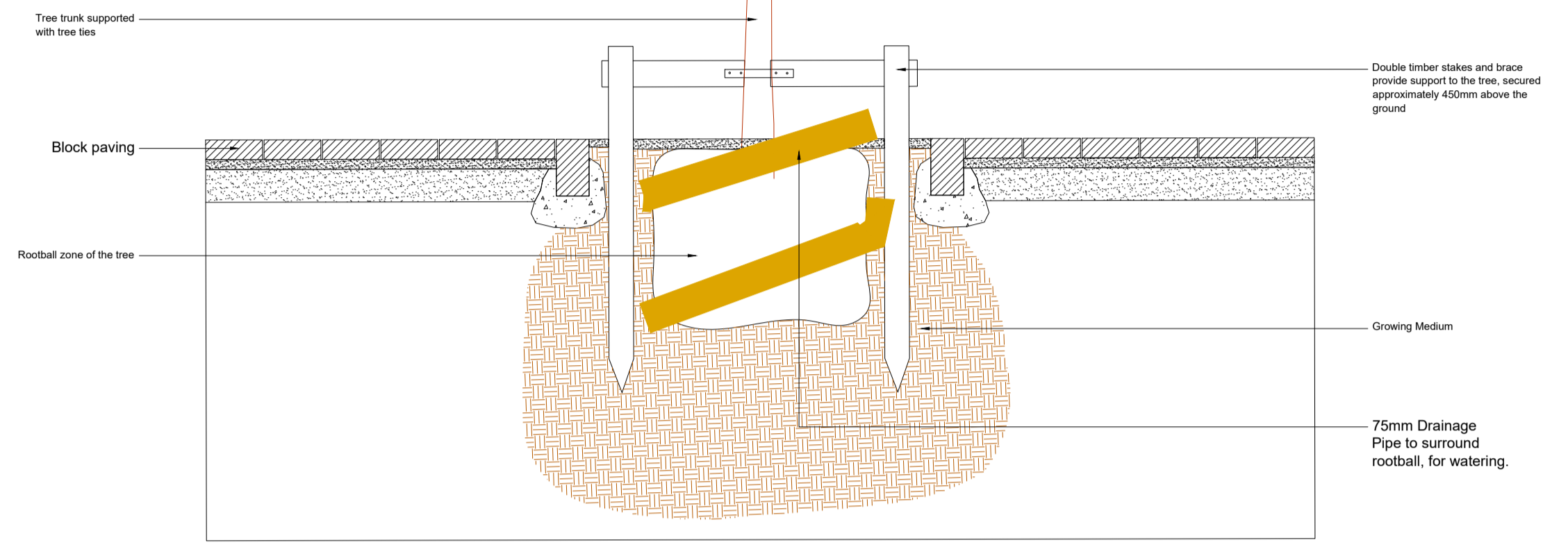

- Tree trunk supported with tree ties
- Block paving
- Rootball zone of the tree
- Double timber stakes and brace provide support to the tree, secured approximately 40mm above the ground
- Growing Medium
- 75mm Drainage Pipe to surround rootball, for watering.

D3 Typical Concrete Pedestrian Footpath Detail
Scale 1:20

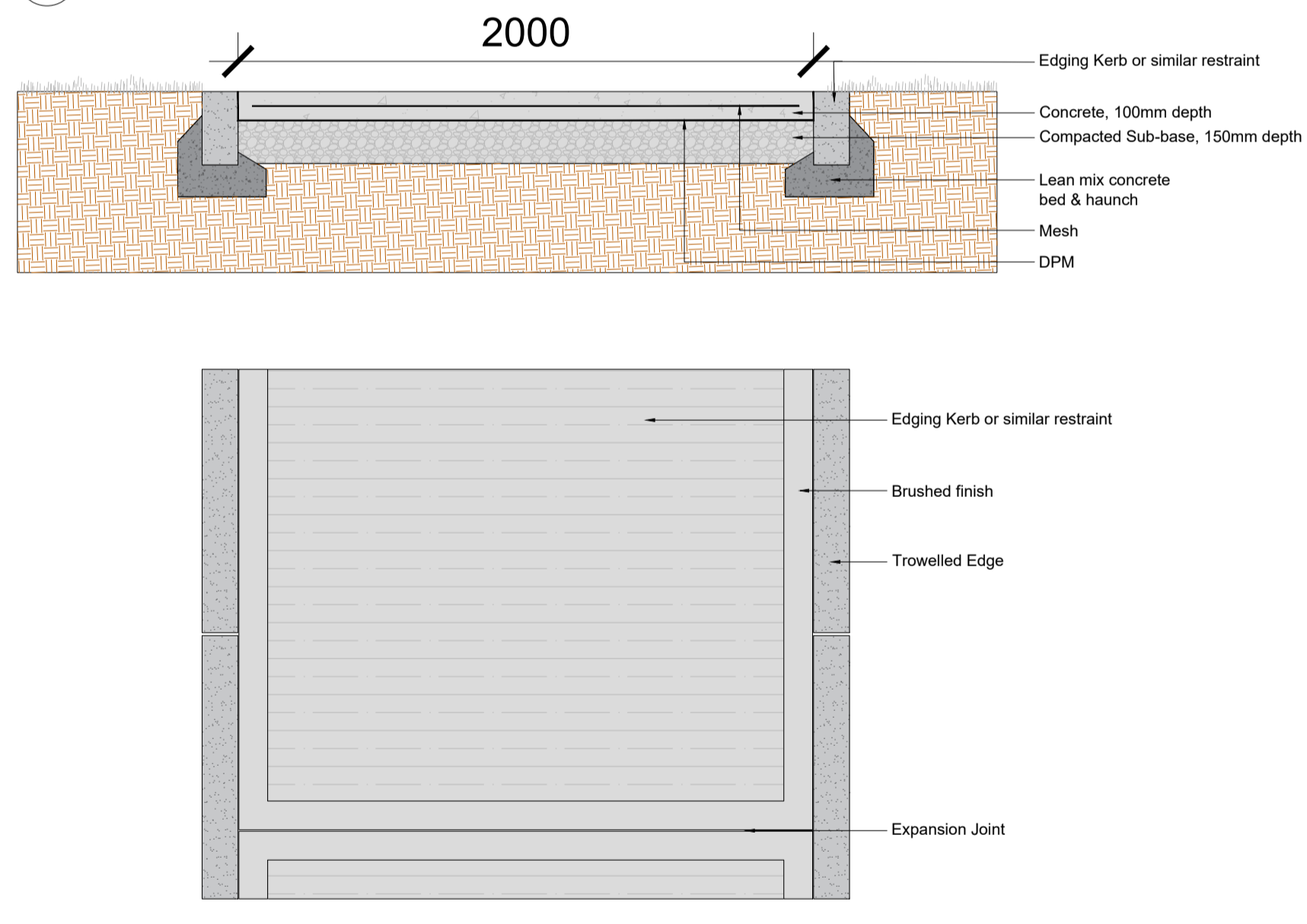

- Edging Kerb or similar restraint
- Concrete, 100mm depth
- Compacted Sub-base, 150mm depth
- Lean mix concrete bed & haunch
- Mesh
- DPM
- Edging Kerb or similar restraint
- Brushed finish
- Trowelled Edge
- Expansion Joint

D4 Ballyusk Quarzite Pedestrian Path w/ Kerb Edge Detail
Scale 1:20

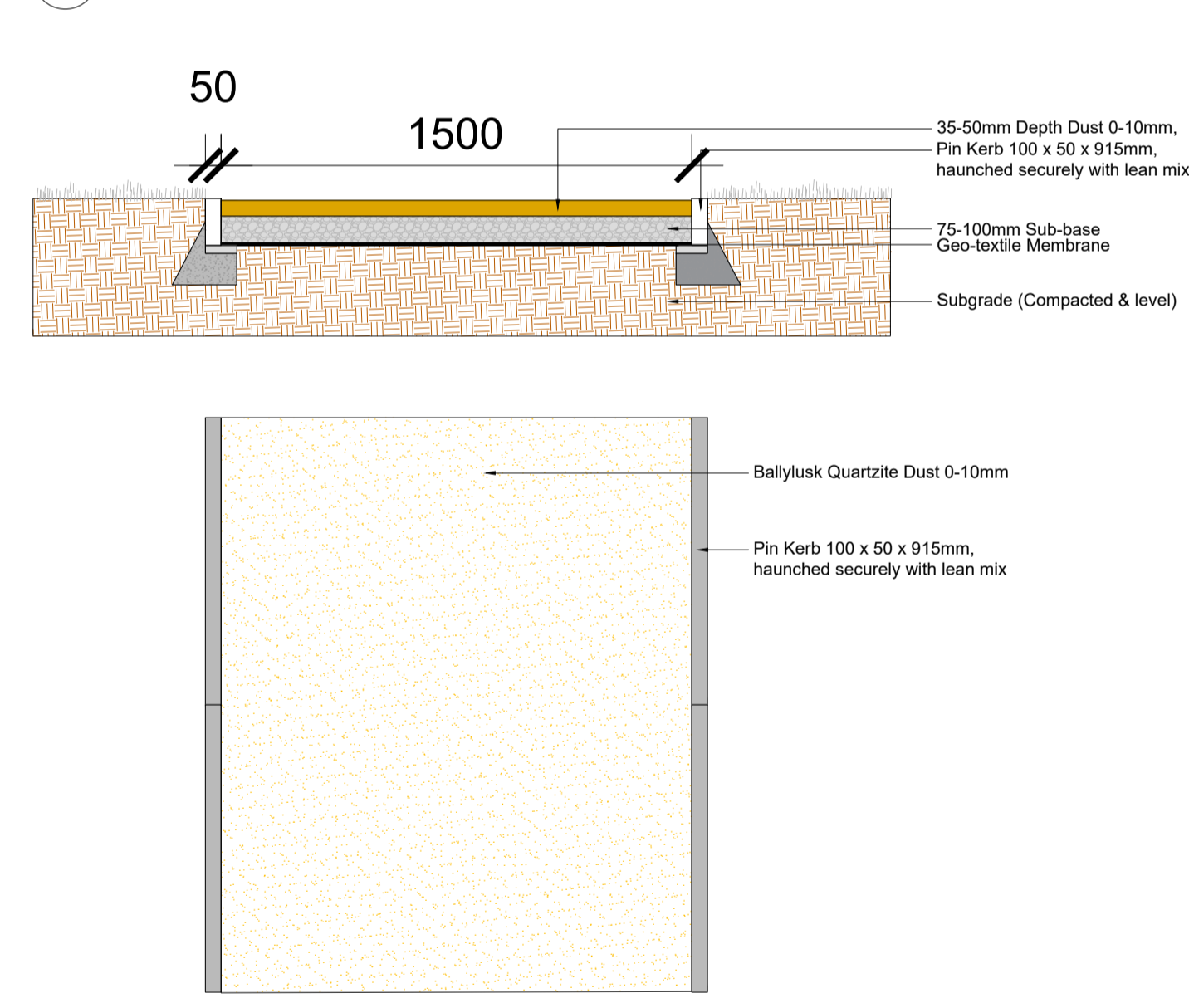

- 35-50mm Depth Dust 0-10mm, Pin Kerb 100 x 50 x 915mm, haunched securely with lean mix
- 75-100mm Sub-base
- Geo-textile Membrane
- Subgrade (Compacted & level)
- Ballyusk Quarzite Dust 0-10mm
- Pin Kerb 100 x 50 x 915mm, haunched securely with lean mix

D6 On-street Tree Planting & Car Parking
Scale 1:20

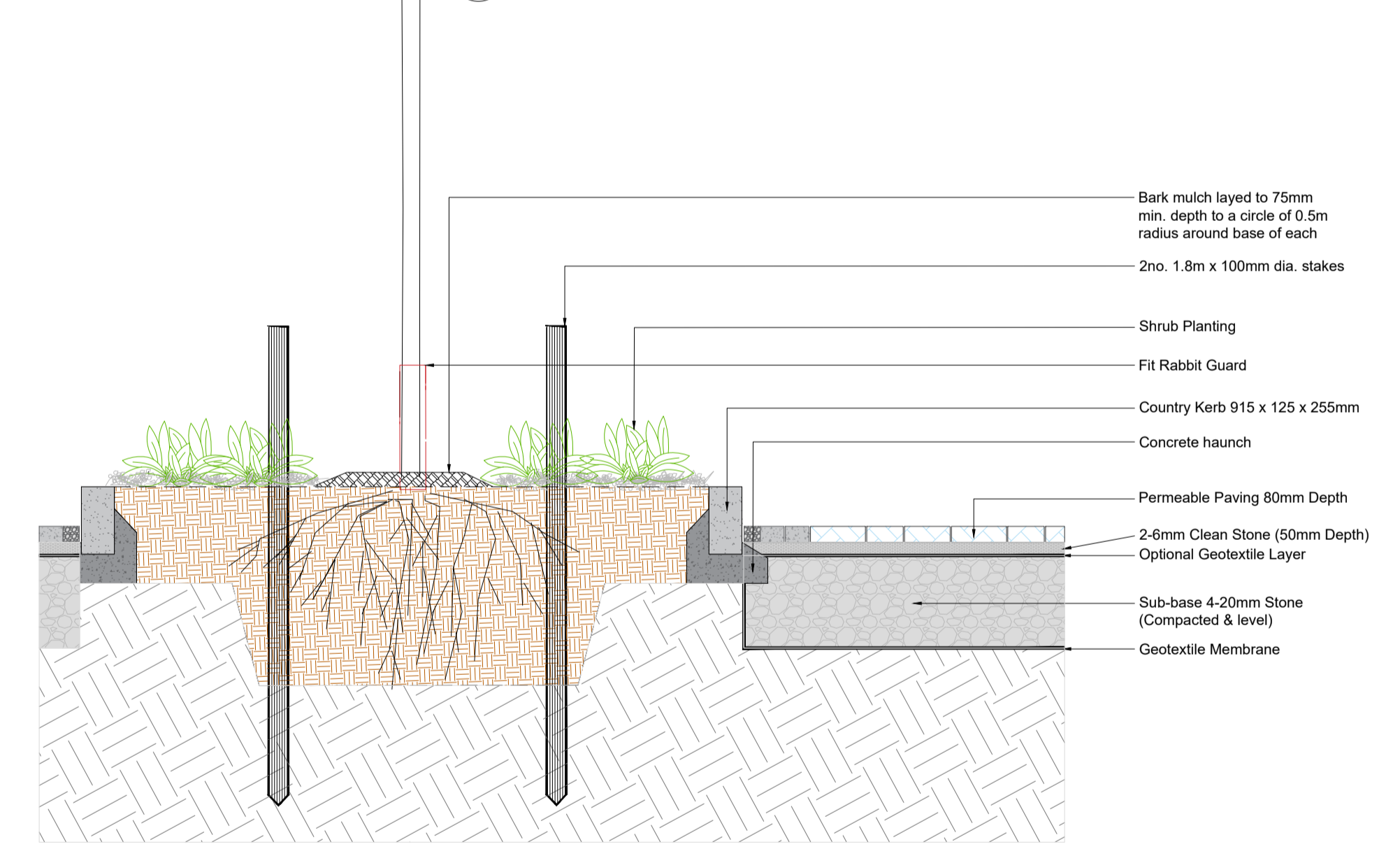

- Bark mulch layed to 75mm min. depth to a circle of 0.5m radius around base of each
- 2no. 1.8m x 100mm dia. stakes
- Shrub Planting
- Fit Rabbit Guard
- Country Kerb 915 x 125 x 255mm
- Concrete haunch
- Permeable Paving 80mm Depth
- 2-6mm Clean Stone (50mm Depth)
- Optional Geotextile Layer
- Sub-base 4-20mm Stone (Compacted & level)
- Geotextile Membrane

Project Title: Residential Development at Former Teagasc Lands, Kinsealy, Fingal, County Dublin					Client: L.D.A.		Dwg No. DWG.3.4																																																			
					Drawing Title: Hard Landscape Details		Scale: 1:500																																																			
					Job No. 1713		Date 10/02/2025																																																			
<table border="1"> <thead> <tr> <th>REV</th> <th>DATE</th> <th>BY</th> <th>CHECKED</th> <th>DESCRIPTION</th> </tr> </thead> <tbody> <tr> <td>I</td> <td>10/02/2025</td> <td>PL</td> <td>RMD</td> <td>Planning</td> </tr> <tr> <td>H</td> <td>13/09/2024</td> <td>PL</td> <td>RMD</td> <td>Planning</td> </tr> <tr> <td>G</td> <td>01/05/2024</td> <td>PL</td> <td>RMD</td> <td>Planning</td> </tr> <tr> <td>F</td> <td>25/03/2024</td> <td>PL</td> <td>RMD</td> <td>Planning</td> </tr> <tr> <td>E</td> <td>22/02/2024</td> <td>PL</td> <td>RMD</td> <td>Planning</td> </tr> <tr> <td>D</td> <td>27/11/2023</td> <td>PL</td> <td>RMD</td> <td>Planning</td> </tr> <tr> <td>C</td> <td>09/11/2022</td> <td>PL</td> <td>RMD</td> <td>Planning</td> </tr> <tr> <td>B</td> <td>03/11/2022</td> <td>PL</td> <td>RMD</td> <td>Planning</td> </tr> <tr> <td>A</td> <td>19/10/2022</td> <td>PL</td> <td>RMD</td> <td>Planning</td> </tr> </tbody> </table>					REV	DATE	BY	CHECKED	DESCRIPTION	I	10/02/2025	PL	RMD	Planning	H	13/09/2024	PL	RMD	Planning	G	01/05/2024	PL	RMD	Planning	F	25/03/2024	PL	RMD	Planning	E	22/02/2024	PL	RMD	Planning	D	27/11/2023	PL	RMD	Planning	C	09/11/2022	PL	RMD	Planning	B	03/11/2022	PL	RMD	Planning	A	19/10/2022	PL	RMD	Planning	 <p>RMDA LANDSCAPE ARCHITECTS + CONSULTANTS</p>		<p>Ronan MacDiarmada + Associates Ltd. Landscape Architects and Consultants.</p> <p>5 Tootenhill, Rathcoole, Co. Dublin tel: +353 1 412 4476 mob: 086 26 25 438 fax: +353 1 401 3748 e-mail: ronan@rmda.ie</p>	
REV	DATE	BY	CHECKED	DESCRIPTION																																																						
I	10/02/2025	PL	RMD	Planning																																																						
H	13/09/2024	PL	RMD	Planning																																																						
G	01/05/2024	PL	RMD	Planning																																																						
F	25/03/2024	PL	RMD	Planning																																																						
E	22/02/2024	PL	RMD	Planning																																																						
D	27/11/2023	PL	RMD	Planning																																																						
C	09/11/2022	PL	RMD	Planning																																																						
B	03/11/2022	PL	RMD	Planning																																																						
A	19/10/2022	PL	RMD	Planning																																																						
This Drawing is Copyright ©																																																										